

Quick-Start Guide

Wyse® P Class Zero Clients, Model Px0

Product: P20

See accompanying documents in the shipping carton for License Agreement and Warranty information. To find the latest Quick-Start Guide, go to <http://www.wyse.com/manuals> and click on the name of your zero client.

Important: A printed copy of the Wyse Technology End User License Agreement is included in the shipping box and provided for your reference only. The license at <http://www.wyse.com/license> as of the purchase date is the controlling licensing agreement. By copying, using, or installing the software or the product, you agree to be bound by those terms.

Caution: Improper connection, mounting, or use of this product could result in component failure or undesired interference. Read Caution Statements before setting up and operating the zero client.

Initial Environment Setup

The Wyse P20 is a workstation-class zero client for use with PC-over-IP® (PCoIP®) protocol environments. The zero client connects to a host server which is PCoIP capable.

Before setting up and using the zero client, you must have a properly installed PCoIP environment that it can access. This guide will help you to set up the zero client and establish a remote connection to your host server using PCoIP® technology, enabling you to use applications and desktop peripherals as if you were using them locally.

Note: PCoIP technology is designed to deliver a user desktop from a centralized host server across standard IP networks – including full DVI dual monitor video, complete USB 1.1 compatibility, and full-duplex high-definition audio.

Setting Up Your Zero Client

Before setting up and operating the zero client, read all **Caution Statements**. Refer to the figures and proceed as follows:

1. Place the zero client on a desk; be sure the monitor and the zero client are turned off and disconnected from AC power.
2. Make all desired connections. The monitor, keyboard with mouse, and Ethernet network are required. Additional connections of peripheral devices may be made at this time.
3. Connect the power adapter to the zero client power input before connecting to a 100-240V AC, 50-60 Hz electrical outlet. When AC power is applied, indicator light is amber.
4. Press zero client *Power Button* to apply power. The power button will light green; wait for the monitor to display the On Screen Display (OSD).

Zero client LED indicators include:

- Off: AC power is off.
- Amber: AC power is on and zero client power is off.
- Green: Zero client power is on.
- Blinking green: Host server is in low-power state.

Note: If the monitor does not show the OSD, check all connectors and be sure the monitor and zero client are turned on.

Note: For more information refer to the user and administrators guides, or contact your Wyse sales representative.

Features

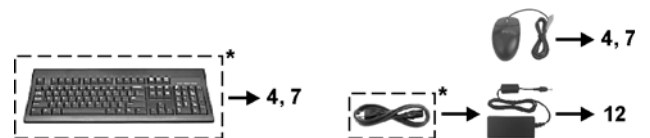
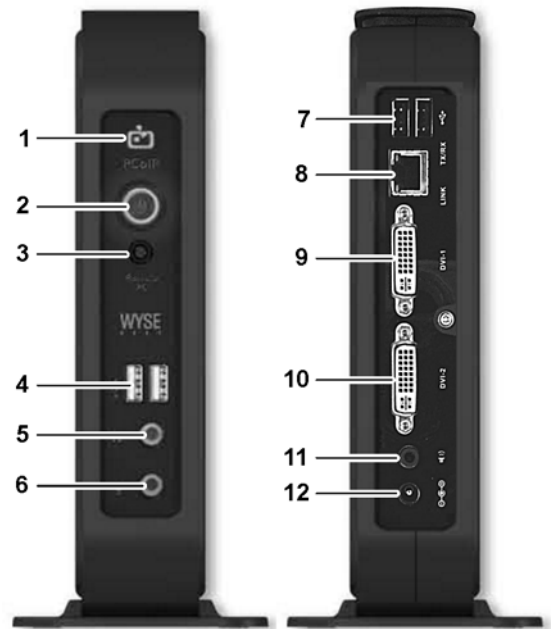

* Supplied for U.S.A.; in other locales, check package contents or contact your Wyse reseller.

- 1 PCoIP LED
- 2 Zero client power button and LED
- 3 Remote host control power button
- 4 USB port (2)¹
- 5 Headphone out²
- 6 Microphone in
- 7 USB port (2)¹
- 8 Ethernet port
- 9 DVI #1 port (1x DVI-I)
- 10 DVI #2 port (1x DVI-I)
- 11 Line out
- 12 +12VDC Power adapter input

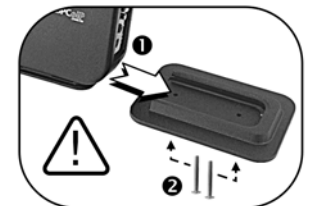

¹ Not all USB devices are supported; check with Wyse or your Wyse representative to find out if a particular device is supported on your zero client.

² **Warning:** Adjustment of the volume control or the equalizer beyond the center position may increase the earphones/headphones output voltage and sound pressure level.

Additional Notes

Monitor Types: In addition to DVI monitors, the zero client is compatible with analog VGA and digital HDMI monitors. Simply attach a DVI-to-VGA or DVI-to-HDMI adapter to the DVI connector on the zero client (only display is supported with DVI-to-HDMI adapter, not audio).

Audio: The zero client uses the Realtek High-Definition Audio Codec. Windows Vista natively contains an HD Audio driver for this Codec. For other operating systems, including Windows XP, install the High-Definition Audio Codec driver from www.realtek.com to use the full audio capabilities of PCoIP.

IP Address: The zero client is set to *DHCP client* mode by default. Normally, the IP address of the zero client and host server are assigned by the DHCP server on your IP network. If your IP network does not have a DHCP server, the zero client and host server will fall back to a static IP address mode after a time-out period of approximately 2 minutes. In the fall back static IP address mode, you can access the zero client to disable *DHCP client* mode and assign a static IP address. The zero client fall back IP address is **192.168.1.50**.

Power Buttons:

The zero client *Power Button* is a multi-function button.

- Press the button: Turns on the zero client.
- Press and hold the button until light turns to amber: Turns off the zero client.
- Press the button when zero client is connected in a session: Disconnects zero client from the host server.

The zero client *Remote PC Power Button* is used to remotely control the front-panel power switch of the host server. To enable this function, the cables of the PCoIP host server power button must be set up to support the feature.

- Press the button (< 4 seconds): The host server goes into, or wakes out of, a sleep state.
- Press and hold the button (> 4 seconds): Turns on, or turns off, the host server.

Configure

The zero client can be configured to use DHCP or Static IP addressing. To change the settings, in the *On Screen Display* go to **Options | Configuration | Network** tab. You may need to unlock the settings page with a password (default password is **Administrator**).

Establishing a PCoIP Connection

1. Turn on the zero client. Wait until the *Connect* command button on the zero client user screen is active for use (no longer grayed out=active).
2. Using the mouse connected to the zero client, click **Connect**. The message "*Discovering hosts, please wait ...*" will appear. After host discovery is complete, a list of available hosts on the network will appear.

 **Note:** If the *Connect* command button on the zero client user screen is inactive (grayed out=inactive) or if the zero client cannot discover host servers on the network, check the network connection and be sure the Ethernet switch or router is turned on.

3. Select the host to which you want to connect and click **OK**. After a successful PCoIP connection, the PCoIP LED of the zero client will light green. You are now connected.

Caution Statements

Improper connection, mounting, or use of this product could result in component failure or undesired interference. Read the following caution statements before setting up and operating the zero client.

Setup

- Do not connect to AC power until all other connections (including the power adapter) are made. Connecting or disconnecting components or equipment on the back panel when the zero client is receiving AC power can cause power surges and damage the device.
- Do not force a connector into its socket. If any undue resistance is encountered, ensure that the connector is correctly oriented to the receptacle.

Venting and Care

- Mount the zero client only as shown or in accordance with the instructions provided with Wyse-approved mounting accessory kits. Improper orientation could inhibit the dissipation of heat from the device and damage it.
- Allow sufficient space around the zero client for ventilation; do not place the device in any enclosure that restricts airflow around the device; do not place any objects on the device. Find environmental operating specifications in the zero client datasheet located at:
<http://www.wyse.com/products>

Power Sources

- To ensure regulatory compliance, use only the power adapter included in the shipping carton, or a Wyse-approved equivalent, with the zero client. Refer to the regulatory notices in the zero client documentation.
- When turning off the zero client, be sure to perform a complete shutdown (via the power button). Do not disconnect the AC power cord, DC power cord, or shut off power at a circuit breaker (including power strips), etc., to turn off the device.
- Surge protectors for electrical devices are recommended in areas of lightning. However, when lightning is occurring, your equipment should be properly shut down and unplugged from AC power until the storm has passed.

Need more information?

Wyse Service and Support - Upgrade software images for installation on your FTP file server are available at:
<http://www.wyse.com/support>

Wyse and the Environment - Information about Wyse compliance with RoHS and with the Waste Electrical and Electronic Equipment (WEEE) is available at:
<http://www.wyse.com/green>

Wyse Warranty Registration - Wyse's warranty registration* process is available at:
<http://www.wyse.com/serviceandsupport/register.asp>

*The standard warranty is three years from the date of purchase

